

St. Helens Arts & Cultural Commission Meeting

Wednesday, December 8, 2010, 6:30 p.m.

Council Chambers, City Hall

1. Call Meeting to Order
2. Visitors Address the Commission – Comments limited to 3 minutes
Topics needing further consideration will be added to the next agenda
3. Approval of Minutes for October 27, 2010
4. Review of November 2010 Fiscal Report
5. Chair & Vice Chair Appointments
6. Old Business
 - Gateway Project Update
 - 5 Year Plan Review Update
 - CC Rider Transit Center Update
 - Island Study Update
 - Banner Update including CRPUD Pole Installations
 - Public Art Review Update
 - ACC Ordinance Review Update
7. New Business
8. Next Meeting: Wednesday, January 26, 2011
9. Adjournment

If you would like to know what other City Boards and Commissions are doing, you may review their minutes on the City's website at www.ci.st-helens.or.us.

City of St. Helens
Arts & Cultural Commission
Minutes from Wednesday, October 27, 2010
City Council Chambers

Members Present

Cathy Lambert, Chair
Anne Parrott
Pam Powell
Kannikar Petersen
Luanne Kreutzer
Jarred Kearsley

Councilors in Attendance

Randy Peterson, Mayor

Staff Present

Margaret Jeffries, Library Director
Crystal Farnsworth, Commission Secretary

Members Absent

Will Gillis-with notification

Guests

Janet Wright
Devin Matlock
Jonathan Wacker
Samuel Jensen
Susan Jensen

❧

CALL PUBLIC HEARING TO ORDER

The public hearing was called to order at 6:30 p.m. by Chair Lambert.

VISITOR COMMENTS

There were no visitor comments.

APPROVAL OF MINUTES FROM MAY 26TH 2010 AND SEPTEMBER 29TH 2010

Commissioner Pam Powell made a motion to approve the minutes from May 26th 2010. Commissioner Anne Parrott seconded the motion. The motion was carried unanimously.

Commissioner Parrot made a motion to approve the minutes from September 29th, 2010. Commissioner Kannikar Petersen seconded the motion. The motion was carried unanimously.

REVIEW OF SEPTEMBER 2010 FISCAL REPORT

There were no changes and no discussion.

OLD BUSINESS

5 YEAR PLAN REVIEW

Commissioner Parrot and Commissioner Powell have reviewed the 5 Year Plan and have suggestions for updates. They will review the update and report back to the Commission.

FUTURE PROJECTS

Commissioner Petersen talked about the future projects report that she put together. She would

like to add Highway 30 as a focus area for future art projects to make the City look more inviting. She would like to install illuminated art that looks like a gateway. She said that ODOT Road would be willing to work with the Commission and come to a meeting regarding art possibilities. The Commission formed a subcommittee to address the Gateway Project.

ACC ORDINANCE REVIEW

Commissioner Petersen recommended setting a minimum cost of \$750.00 for an art project—approximately five times the cost to hold the public hearing to approve the art—and setting a minimum size of 2' x 2' x 2' before a public hearing must be held to approve art. She said it would save time and money. Commissioner Powell said she would like to change the language from "the Commission is allowed to make a recommendation" to "the Commission may make a recommendation" so that the Commission can have more leeway in holding public hearings. The changes will be forwarded to Chad Olsen, City Administrator, for review.

PUBLIC ART COLLECTION INVENTORY UPDATE

Library Director Jeffries sent out notice to the department heads. City Administrator Olsen has assigned someone at City Hall to do the inventory there. The Police Chief has said there is no art in the Police Station. Library Director Jeffries is doing the inventory at the Library. Dale Goodman, Public Works Director, will do the Public Works inventory, and Chair Lambert will inventory all art commissioned by the Arts & Cultural Commission.

13TH ST & COLUMBIA BLVD ISLAND STUDY UPDATE

The City is studying the island in conjunction with the TSP update on November 4th. Per the municipal code, Commissioner Petersen said that anything in the restrictive zone on the island has to be under 3 feet tall or over 8 feet tall. In the other areas on the island, you can put tall landscaping. Mayor Randy Peterson said that there are people on staff that can evaluate visual clearance issues.

BANNER UPDATE

Aluminum has been obtained and Chair Lambert is in contact with the artists. A date needs to be decided for when the art is due. Commissioner Parrott said the end of March would be a good date to set the completion time. Commissioner Petersen talked to Sue Nelson, Civil Engineer Supervisor, and the permit has been approved by the City. A historic pole needs to be installed for the banner by The Vault.

NEW BUSINESS

COLUMBIA COUNTY RIDER-JANET WRIGHT

Janet Wright told the Commission that there are new drawings of the transit center on the Rider website. They would like to have colorful bike racks and benches installed. Commissioner Petersen suggested having high school students manufacture the bike racks. She also suggested stationary trash cans be installed with art, such as mosaics, incorporated into the design. Margaret Jeffries, Library Director, said she has contacted Lisa Scholl to see if the City has a contract or agreement for locating artwork on private property. Janet Wright said she was interested in inserting colored tiles into the concrete sidewalks. Commissioner Powell and Commissioner Petersen will work with Janet Wright regarding potential art projects.

NEXT MEETING

The next regular meeting is scheduled for Wednesday, December 8th at 6:30 p.m.

ADJOURNMENT

The meeting was adjourned at 7:40 p.m.

CR

Submitted by:
Crystal Farnsworth
Commission Secretary

Approved by the Commission: _____

Accepted by the Council: _____

Present=P Absent=A

Date	Kearsley	Lambert	Parrott	Petersen	Powell	Williams	Position 7
January 27 regular meeting	P	P	P	N/A	P	A	VACANT
February 22 regular meeting*	P	P	P	P	P	P	VACANT
Date	Kearsley	Lambert	Parrott	Petersen	Powell	Williams	Gillis
March 24 regular meeting	P	P	P	P	P	A	P
April 28 regular meeting	A	A	P	P	P	A	P
May 17 Public Hearing	A	P	P	P	A	A	P
May 26 regular meeting							
June 23 regular meeting	CANCELLED	CAN	CAN	CAN	CAN	CAN	CAN
Date	Kearsley	Lambert	Parrott	Petersen	Powell	Vacant	Gillis
July 28 regular meeting	A	P	P	P	P	VACANT	P
August 25 PH & PM	A	P	P	P	P	VACANT	P
Date	Kearsley	Lambert	Parrott	Petersen	Powell	Kreutzer	Gillis
September 29 regular meeting & public hearing	P	P	P	P	P	P	p
October 27 regular meeting	P	P	P	P	P	P	A
November 18 regular meeting	CANCELLED	CAN	CAN	CAN	CAN	CAN	CAN
December 16 regular							

* Date changed from February 24

General Ledger
Detailed Trial Balance

User: CRYSTAL
Printed: 12/06/2010 - 10:55
Period 5, 2011



Account Number	Description	Budget	Beginning Balance	Debit This Period	Credit This Period	Ending Balance
001	CITY GENERAL FUND					
EXPENSE						
001-001	CITY ADMINISTRATION					
001-001-477000	Public Art Expense	15,000.00				
	001-001-477000 Totals:		Var: 14,700.00	15,000.00	300.00	0.00
	001-001 EXPENSE Totals:	15,000.00		300.00	0.00	300.00
	EXPENSE Totals:	15,000.00		300.00	0.00	300.00
	001 Totals:	(15,000.00)		300.00	0.00	300.00
	Report Totals:	(15,000.00)		300.00	0.00	300.00

ARTS & CULTURAL COMMISSION

TRIAL BALANCE

November 2010

Budget for 2010-2011

\$ 15,000.00

Monthly Beginning Balance

\$ 14,700.00

Beginning Total Allocated Funds

\$ 32,672.54

Monthly Ending Balance

\$ 14,700.00

Ending Total Allocated Funds

\$ 32,672.54

Summary Arts and Cultural Commission
 23-Aug-10

Revenues

Elk Ridge Reservoir Total Project- \$1,103,263	\$ 5,516.32	0.50%
Kavanaugh Sewer -City only Total Project-\$226,030.91	\$ 1,130.15	0.50%
Senior Center- Total Project \$1,200,000	\$ 18,000.00	1.50%
Sewer I/I 2008-09 Total Project-\$2,000,000	\$ 10,000.00	0.50%
Sewer I/I 2009-10 \$4,500,000	\$ 22,500.00	0.50%
Sewer I/I 10-11 \$4,000,000	\$ 20,000.00	0.50%
Total Revenue	\$ 71,630.15	

Expenditures

F/Y 05-06	\$ 18,463.08
F/Y 06-07	\$ (1,928.88)
F/Y 07-08	\$ 15,000.09
F/Y 08-09	\$ 3,547.25
F/Y 09-10	\$ 3,808.87
F/Y 10-11	\$ 67.20
Total	\$ 38,957.61

Balance **\$ 32,672.54**

Plus Michael Curry \$ 5,000.00

LIST OF ST HELENS PUBLIC ARTS COLLECTION

TYPE: Painting, Drawing, Print, Photograph, Sculpture, Monument, Fixture, etc
 MEDIUM: Paper, Wood, Hide, Metal, Concrete, Stone, Straw, etc
 VALUE: Estimated replacement value
 MAINTENANCE SCHEDULE: Method and schedule to maintain the artwork
 FILE NAME: Digital photos of the artwork. Please begin the name of the file with the location such as lib for library, cit for city hall, par for park, str for street, etc. For 3 dimensional objects, please provide at least 2 photos of different views.

LOCATION	Columbia View Park		
TITLE	Seaman	ARTIST'S NAME	Robert Tidwell
TYPE	Sculpture	MEDIUM	wood, paint
SIZE	1'W x 3'L x 2'H		
VALUE	\$750		
YEAR CREATED	2004	YEAR ACQUIRED	2004
MAINTENANCE SCHEDULE	Repaint every 3 years w/ exterior paint to match original. Inspect for wood rot yearly. Repair any damages w/ exterior wood filler and touch up as needed.		
LAST MAINTAINED	July 2010?		
FILE NAME	par_seam1.jpg, par_seam2.jpg		
DESCRIPTION / INFORMATION	Sculpture of Seaman the dog was commissioned by the Columbia County Historical Society and donated to the City.		

LOCATION	PW DIRECTOR'S OFFICE		
TITLE	YACHTS OF AMERICA'S CUP	ARTIST'S NAME	THOMPSON
TYPE	PRINT	MEDIUM	PAPER
SIZE	22x26		
VALUE	?		
YEAR CREATED	?	YEAR ACQUIRED	?
MAINTENANCE SCHEDULE	NONE		
LAST MAINTAINED	DUSTED MONTHLY		
FILE NAME			
DESCRIPTION / INFORMATION	OAK FRAMED, MATTED, GLASS, L.E., 4-PRINT SET		

LOCATION	PW DIRECTOR'S OFFICE		
TITLE	BOUNDARY WATERS	ARTIST'S NAME	LEO STANS
TYPE	PRINT	MEDIUM	PAPER
SIZE	18x22		
VALUE	?		
YEAR CREATED	1990	YEAR ACQUIRED	?
MAINTENANCE SCHEDULE	NONE		
LAST MAINTAINED	DUSTED MONTHLY		
FILE NAME			
DESCRIPTION / INFORMATION	OAK FRAMED w/GLASS, MATTED, L.E., 2-PRINT SET		

LIST OF ST HELENS PUBLIC ARTS COLLECTION

TYPE: Painting, Drawing, Print, Photograph, Sculpture, Monument, Fixture, etc
 MEDIUM: Paper, Wood, Hide, Metal, Concrete, Stone, Straw, etc
 VALUE: Estimated replacement value
 MAINTENANCE SCHEDULE: Method and schedule to maintain the artwork
 FILE NAME: Digital photos of the artwork. Please begin the name of the file with the location such as lib for library, cit for city hall, par for park, str for street, etc. For 3 dimensional objects, please provide at least 2 photos of different views.

LOCATION	ENKINNESSING		
TITLE	PORTLAND / Mt St. Helens	ARTIST'S NAME	ADONISED SATELLITE PRODUCTIONS
TYPE	POSTER	MEDIUM	PAPER
SIZE	25.5 x 39		
VALUE	\$250		
YEAR CREATED	1988	YEAR ACQUIRED	1989
MAINTENANCE SCHEDULE	NONE		
LAST MAINTAINED			
FILE NAME			
DESCRIPTION / INFORMATION	SATELLITE PHOTO OF MT ST. HELENS & PORTLAND IN METAL FRAME		

LOCATION	ENKINNESSING		
TITLE	TOWN OF ST. HELENS	ARTIST'S NAME	CT BREWSTER & CO
TYPE	BLACK & WHITE LITHOGRAPH	MEDIUM	PAPER
SIZE	26 x 40		
VALUE	?		
YEAR CREATED	?	YEAR ACQUIRED	?
MAINTENANCE SCHEDULE	NONE		
LAST MAINTAINED			
FILE NAME			
DESCRIPTION / INFORMATION	BLACK/WHITE LITHOGRAPH OF EARLY TOWN OF ST. HELENS PLOT IN METAL FRAME		

LOCATION	ENKINNESSING		
TITLE	YACHTS OF THE AMERICAS	ARTIST'S NAME	THOMPSON
TYPE	PRINT	MEDIUM	PAPER
SIZE	22 x 26		
VALUE	?		
YEAR CREATED	?	YEAR ACQUIRED	?
MAINTENANCE SCHEDULE			
LAST MAINTAINED			
FILE NAME			
DESCRIPTION / INFORMATION	WOOD FRAME W/ GLASS, MOTTED, L.E.		

LIST OF ST HELENS PUBLIC ARTS COLLECTION

TYPE: Painting, Drawing, Print, Photograph, Sculpture, Monument, Fixture, etc
 MEDIUM: Paper, Wood, Hide, Metal, Concrete, Stone, Straw, etc
 VALUE: Estimated replacement value
 MAINTENANCE SCHEDULE: Method and schedule to maintain the artwork
 FILE NAME: Digital photos of the artwork. Please begin the name of the file with the location such as lib for library, cit for city hall, par for park, str for street, etc. For 3 dimensional objects, please provide at least 2 photos of different views.

LOCATION	ENGINEERING		
TITLE	-	ARTIST'S NAME	-
TYPE	PHOTOS	MEDIUM	PAPER
SIZE	30x18		
VALUE	?		
YEAR CREATED	?	YEAR ACQUIRED	2007 ?
MAINTENANCE SCHEDULE			
LAST MAINTAINED			
FILE NAME			
DESCRIPTION / INFORMATION	15 4x6 PHOTO = w/ CAPTIONS IN METAL FRAME w/ GLASS		

LOCATION	CITY HALL		
TITLE	OSPREY LOOKOUT	ARTIST'S NAME	JESS SWICKARD
TYPE	BENCH	MEDIUM	STEEL
SIZE	16" T 18" x 60"		
VALUE	?		
YEAR CREATED	2007	YEAR ACQUIRED	2007
MAINTENANCE SCHEDULE			
LAST MAINTAINED			
FILE NAME			
DESCRIPTION / INFORMATION	STEEL BENCH w/ OSPREY W BUILT		

LOCATION	COLUMBIA VIEW PARK		
TITLE	MOSAIC HAND TILES	ARTIST'S NAME	GRADE SCHOOL CHILDREN - VARIOUS
TYPE	MOSAIC	MEDIUM	HAND PAINTED CERAMIC TILES
SIZE	67 x 24		
VALUE	\$7200		
YEAR CREATED	2006	YEAR ACQUIRED	2006
MAINTENANCE SCHEDULE			
LAST MAINTAINED			
FILE NAME			
DESCRIPTION / INFORMATION			

LIST OF ST HELENS PUBLIC ARTS COLLECTION

TYPE: Painting, Drawing, Print, Photograph, Sculpture, Monument, Fixture, etc
 MEDIUM: Paper, Wood, Hide, Metal, Concrete, Stone, Straw, etc
 VALUE: Estimated replacement value
 MAINTENANCE SCHEDULE: Method and schedule to maintain the artwork
 FILE NAME: Digital photos of the artwork. Please begin the name of the file with the location such as lib for library, cit for city hall, par for park, str for street, etc. For 3 dimensional objects, please provide at least 2 photos of different views.

LOCATION	COLUMBIA VIEW PARK		
TITLE	COMMEMORATIVE MEDALLION	ARTIST'S NAME	
TYPE		MEDIUM	PAINT / CONCRETE
SIZE	4 1/2" DIAMETER		
VALUE	~5000 ⁰⁰		
YEAR CREATED	?	YEAR ACQUIRED	2007?
MAINTENANCE SCHEDULE	AS NEEDED		
LAST MAINTAINED	?		
FILE NAME			
DESCRIPTION / INFORMATION			

LOCATION	EAST CLIFFS PARK		
TITLE	CERAMIC TILE FISH	ARTIST'S NAME	SUMNERLORETS ACADEMY STUDENTS
TYPE	SCULPTURE	MEDIUM	CONCRETE & CERAMIC TILE
SIZE	6'x7'8" x 44"		
VALUE	~2000 ⁰⁰		
YEAR CREATED	2008	YEAR ACQUIRED	2008
MAINTENANCE SCHEDULE	ANNUAL CLEANING		
LAST MAINTAINED	2010		
FILE NAME			
DESCRIPTION / INFORMATION	CERAMIC TILE & CONCRETE SCULPTURE OF LEAPING FISH		

LOCATION	WALNUT TREE PARK		
TITLE	BLACK WALNUT TREE BENCH	ARTIST'S NAME	COLE SUMMISON, HIGH SCHOOL STUDENTS
TYPE	PAINTED BENCH	MEDIUM	STEEL & PAINT
SIZE	2'9" x 7'2" x 4'1"		
VALUE	~1500 ⁰⁰		
YEAR CREATED	2007	YEAR ACQUIRED	2007
MAINTENANCE SCHEDULE	ANNUAL TOUCH-UP OF PAINT		
LAST MAINTAINED	2010		
FILE NAME			
DESCRIPTION / INFORMATION			

LIST OF ST HELENS PUBLIC ARTS COLLECTION

TYPE: Painting, Drawing, Print, Photograph, Sculpture, Monument, Fixture, etc
 MEDIUM: Paper, Wood, Hide, Metal, Concrete, Stone, Straw, etc
 VALUE: Estimated replacement value
 MAINTENANCE SCHEDULE: Method and schedule to maintain the artwork
 FILE NAME: Digital photos of the artwork. Please begin the name of the file with the location such as lib for library, cit for city hall, par for park, str for street, etc. For 3 dimensional objects, please provide at least 2 photos of different views.

LOCATION	WALNUT TREE PARK		
TITLE	WTP SIGN	ARTIST'S NAME	?
TYPE	BRUN	MEDIUM	PAINT & WOOD
SIZE	4" x 24" x 54"		
VALUE	3500 ⁰⁰		
YEAR CREATED	?	YEAR ACQUIRED	2004 ?
MAINTENANCE SCHEDULE	ANNUAL TOUCH-UP		
LAST MAINTAINED	2010		
FILE NAME			
DESCRIPTION / INFORMATION			

LOCATION	WALNUT TREE PARK		
TITLE	WORLD PEACE SIGN	ARTIST'S NAME	?
TYPE	MONUMENT	MEDIUM	WOOD & PLASTIC
SIZE	6' x 6" x 8"		
VALUE	1200 ⁰⁰		
YEAR CREATED	?	YEAR ACQUIRED	?
MAINTENANCE SCHEDULE	ANNUAL INSPECTION & REPAIR		
LAST MAINTAINED	2010		
FILE NAME			
DESCRIPTION / INFORMATION			

LOCATION	McCORMICK PARK		
TITLE	FISHERMAN	ARTIST'S NAME	ROBERT TROWER
TYPE	SCULPTURE	MEDIUM	WOOD
SIZE	19" x 18" x 80"		
VALUE	1650 ⁰⁰		
YEAR CREATED	2004	YEAR ACQUIRED	2004
MAINTENANCE SCHEDULE	PRESSURE WASH & SEAL EVERY 3 YEARS		
LAST MAINTAINED	2010		
FILE NAME			
DESCRIPTION / INFORMATION			

LIST OF ST HELENS PUBLIC ARTS COLLECTION

TYPE: Painting, Drawing, Print, Photograph, Sculpture, Monument, Fixture, etc
 MEDIUM: Paper, Wood, Hide, Metal, Concrete, Stone, Straw, etc
 VALUE: Estimated replacement value
 MAINTENANCE SCHEDULE: Method and schedule to maintain the artwork
 FILE NAME: Digital photos of the artwork. Please begin the name of the file with the location such as lib for library, cit for city hall, par for park, str for street, etc. For 3 dimensional objects, please provide at least 2 photos of different views.

LOCATION	McCormick Park		
TITLE	FISHERMAN'S DOG	ARTIST'S NAME	ROBERT TIDWELL
TYPE	SCULPTURE	MEDIUM	WOOD
SIZE	12' x 15' x 38"		
VALUE	£2000 ⁰⁰		
YEAR CREATED	2004	YEAR ACQUIRED	200 2004
MAINTENANCE SCHEDULE	PRESSURE WASH & SEAL EVERY 3 YEARS		
LAST MAINTAINED	2010		
FILE NAME			
DESCRIPTION / INFORMATION			

LOCATION	McCormick Park		
TITLE	LEOPIN'S STURGEON	ARTIST'S NAME	ROBERT TIDWELL
TYPE	SCULPTURE	MEDIUM	WOOD
SIZE	30 x 24 x 101		
VALUE	£1000 ⁰⁰		
YEAR CREATED	2004	YEAR ACQUIRED	2004
MAINTENANCE SCHEDULE	PRESSURE WASH & SEAL EVERY 3 YEARS		
LAST MAINTAINED			
FILE NAME			
DESCRIPTION / INFORMATION			

LOCATION	McCormick Park		
TITLE	VENERABLES MEMORIAL	ARTIST'S NAME	?
TYPE	MONUMENT	MEDIUM	BRICK, ROCK, GRANITE
SIZE	2 @ 51 x 116 x 14		
VALUE	?		
YEAR CREATED	2010	YEAR ACQUIRED	2010
MAINTENANCE SCHEDULE	PRESSURE WASH ANNUALLY		
LAST MAINTAINED	—		
FILE NAME			
DESCRIPTION / INFORMATION			



64001 Columbia River Highway
Post Office Box 1193
St. Helens, Oregon 97051

October 14, 2010

(503) 397-1844
FAX (503) 397-5215
<http://www.crpud.net>

City of St. Helens
Attn: Greg Payne
PO Box 278
St. Helens, OR 970510278

Dear Greg:

Thank you for your inquiry regarding the installation of eight (8) street lights at various locations along Old Portland Road in Saint Helens. These lights will be installed on wood poles and I have estimated the installation costs to be as follows:

◆
Board of Directors
David Baker
Carol Everman
Darrel Purkerson
Richard Simpson
Loren Tarbell

General Manager
Kevin P. Owens, P.E.
◆

Labor & Equipment	\$ 3,919.00
Material	\$ 3,803.00
Pole and Anchor Excavation .	\$ 7,000.00
Tree trimming	\$ 1,000.00
Flagging	<u>\$ 2,576.00</u>
Total	\$18,298.00

In addition, you requested a cost estimate to provide tree trimming to improve the effect of the existing lights along Old Portland Road. I have estimated this cost to be as follows:

Tree trimming	\$ 2,000.00
Flagging	<u>\$ 736.00</u>
Total	\$ 2,736.00

The service will be provided in accordance with Columbia River People's Utility District (PUD) General Terms, Conditions, Rules and Regulations for Electric Service. This cost estimate is valid for 180 days from the date of this letter and does not include the monthly energy costs or periodic maintenance costs.

You are required to pay the quoted estimate in full, prior to installation. If the actual cost is less than the quoted estimate, you will be refunded the difference. However, if the actual cost is more than the quoted estimate, you will not be required to pay the difference.

Please sign and return this letter along with your payment, which authorizes the PUD to proceed with the work and that you agree to adhere to the PUD's General Terms for Electric Service.

We look forward to working with you on this project and if you have any questions, please feel free to call me at (503) 366-3244.

Sincerely,



Rod Bennion
Engineering



Customer Signature

Date

Copy: Work Order File 09-11697

LABOR
107 - 100 %

- CHECK LIST**
- Locates
 - Staking
 - Flagging
 - Backhoe
 - Holedigger

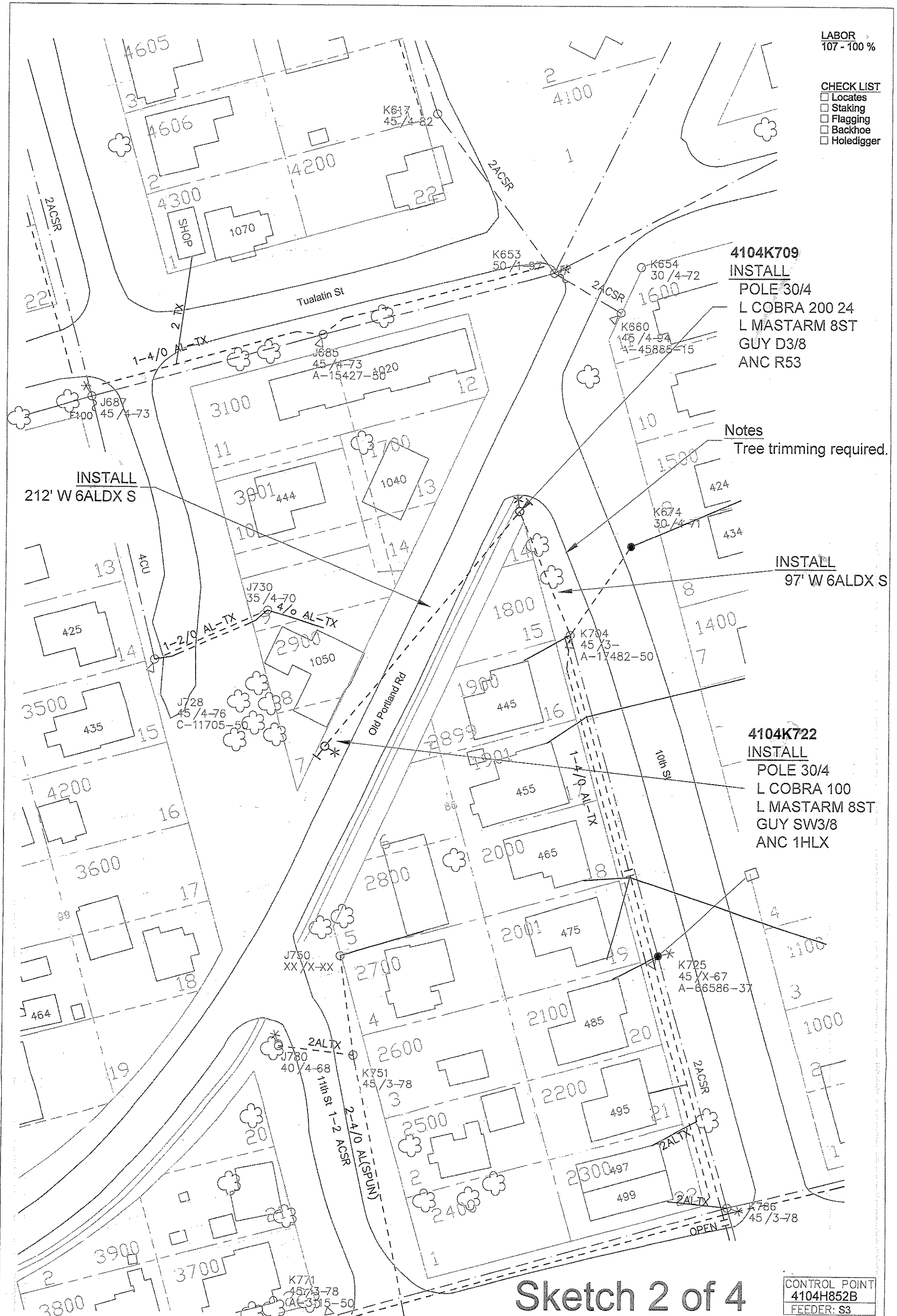

4104K709
INSTALL
POLE 30/4
L COBRA 200 24
L MASTARM 8ST
GUY D3/8
ANC R53

Notes
Tree trimming required.

INSTALL
97' W 6ALDX S

4104K722
INSTALL
POLE 30/4
L COBRA 100
L MASTARM 8ST
GUY SW3/8
ANC 1HLX

Sketch 2 of 4

CONTROL POINT
4104H852B
FEEDER: S3

COLUMBIA RIVER PUD
Job Briefing
1. Hazards associated with the job
2. Work procedures involved
3. Special precautions
4. Energy source controls
5. Personal protective equipment requirements

MAP #:	4104	SCALE:	1"=60	DATE:	01/21/09
TAX CODE:	2-08	DES. BY:	RB	W.O. #:	09-11697
City of St. Helens - Install Street lights				FINAL INSPECTION BY:	
Old Portland Rd., St. Helens				DWG. #:	
				0911697b	

INSTALL
90' W 6ALDX S

4104H889
INSTALL
POLE 30/4
L COBRA 100
L MASTARM 8ST

LABOR
107 - 100 %

CHECK LIST

- Locates
- Staking
- Flagging
- Permits
- Backhoe
- Holedigger

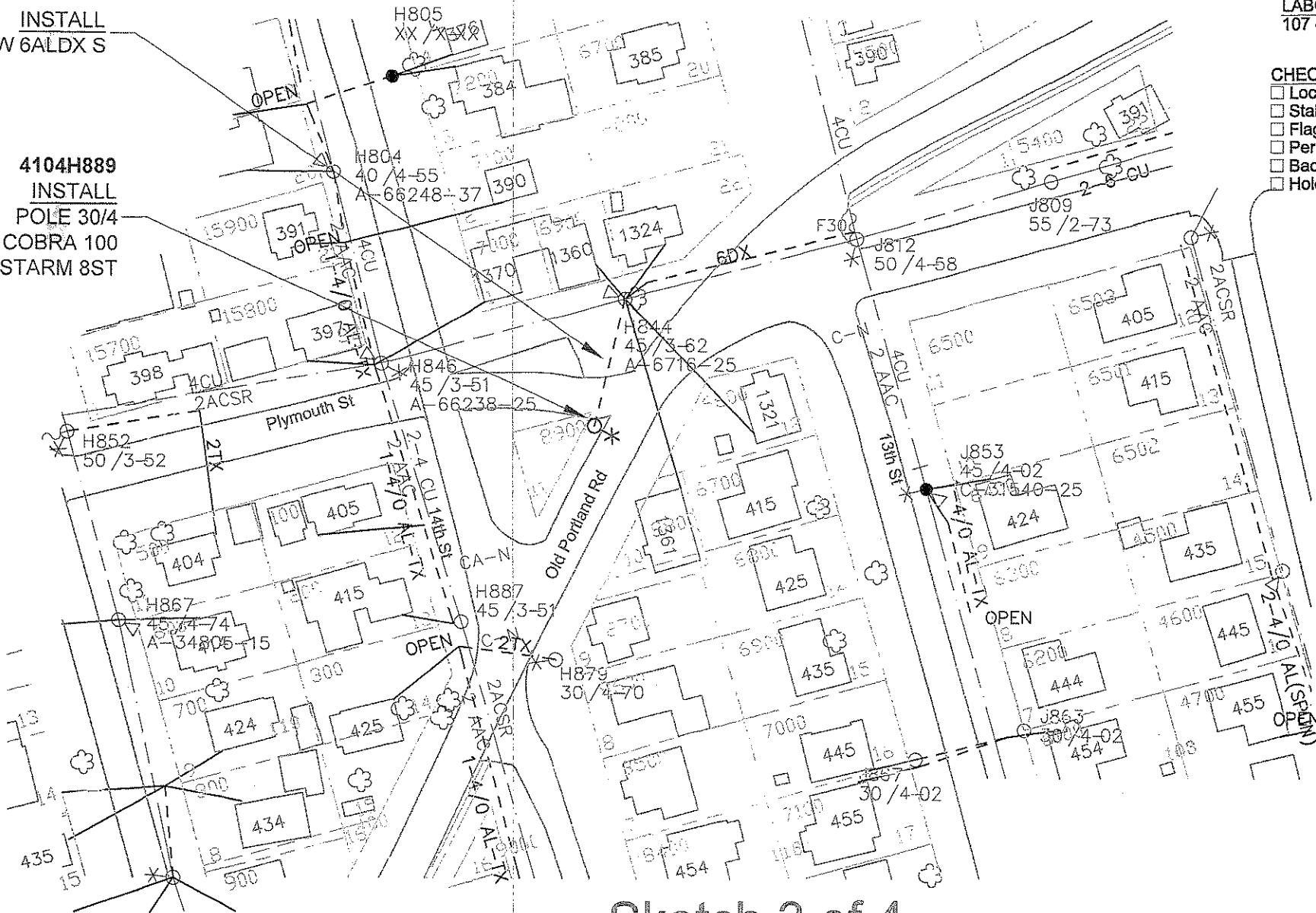

Sketch 3 of 4

COLUMBIA RIVER PUD Job Briefing 1. Hazards associated with the job 2. Work procedures involved 3. Special precautions 4. Energy source controls 5. Personal protective equipment requirements	MAP #	4104	SCALE:	1"=100	DATE:	01/21/09
	TAX CODE:	2-08	DES. BY:	RB	AUTH:	
City of St. Helens - Install Street lights Old Portland Rd., St.Helens					W.O. # 09-11697	
					FINAL INSPECTION BY:	
					DWG. # 0911697c	

- LABOR**
107 - 100 %
- CHECK LIST**
- Locates
 - Staking
 - Flagging
 - Backhoe
 - Holedigger

4109E223
INSTALL
L COBRA 200 3
L MASTARM 8ST

INSTALL
308' W 6ALDX S

4109D298
INSTALL
L COBRA 200 3
L MASTARM 8ST

4109F108
INSTALL
L COBRA 200 3
L MASTARM 8ST

Sketch 4 of 4

COLUMBIA RIVER PUD Job Briefing 1. Hazards associated with the job 2. Work procedures involved 3. Special precautions 4. Energy source controls 5. Personal protective equipment requirements	MAP #:	4109,4104	SCALE:	1"=120	DATE:	01/21/09
	TAX CODE:	2-08	DES. BY:	RB	W.O. #:	09-11697
	City of St. Helens - Install Street Lights				FINAL INSPECTION BY:	
	Old Portland Rd., ST. Helens				DWG. #:	

